

LED power supply

Constant Current Dimming

Compact DALI2

SLD35-1000IBD-UN
SLD35-1000ILD-UN

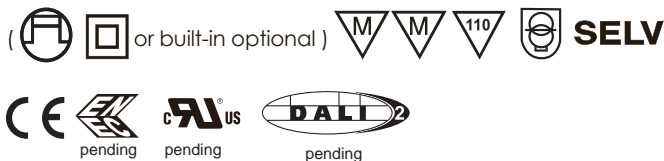

Product description:

This type of compact constant current power supply with 110-277Vac input voltage has very high efficiency and low power loss.

Designed with high power factor and ripple free, it can be used either built-in or independently. The output current can be set by the DIP switch, and the output current can be switched every 50mA from 250mA to 1000mA.

With newest DALI2.0 technology, this power supply can be dim from 1%-100%

It conforms to SELV standard and the built-in protection circuit will shut down the converter in case of such faults as: open circuit, short circuit, over load, over temperature. The power supply will restart automatically after fault correction.

Standards:

EN61347-1
EN61347-2-13
EN61547
EN55015
EN61000-3-2
EN61000-3-3
EN62384
EN62493
UL1310
FCC 15B
EN62386:101,102,207 Version2

Characteristics:

- Independent or built-in power supply for constant current LED lamp
- Multipower driver supplied with dip-switch for the selection of the output current from 250-1000mA
- Class II protection against electric shock for direct or indirect contact
- 1-100% dimming range by DALI2 or High voltage push dimming
- Universal input voltage from 110-277V
- Push-in terminal block for quick connection
- It can be used for lighting equipment in protection class I and II
- Ripple free in all dimming range
- Start-up time $\leq 0.5S$
- Open circuit, short circuit, over load and over temperature protection
- Auto restart after fault conditions removal
- Warranty :5 Years

Specifications:

Model	SLD35-1000IB/LD-UN	
Output	turn on time(S) ¹	<0.5s
	output current(mA) ¹	250/300/350/400/450/500/550/600/650/700/750/800/850/900/950/1000
	output current tolerance ²	+/-5%
	ripple current(%) ³	≤3%
	working voltage range(V)	8-42
	output power range(W)	2-35
	Max. output voltage(V)	55
	output safety rating	SELV
	dimming interface	supplementary insulation DALI2.0 interface
	dimming range	1%-100% linear & exponent
Input	rated supply voltage(Vac)	110-277
	voltage range(Vac)	100-305
	DC voltage range(Vdc)	176-280
	line frequency(Hz)	0/50/60
	input current(mA)	420
	input power(W) ¹	MAX 40
	efficiency ¹	87% (Rrefere to Electrical curves)
	power factor ¹	≥0.95(Rrefere to Electrical curves)
	THD ¹	<10%@230V@full load any current presetting
	inrush current(Ipk) ¹	20A/150μs
Protection	short circuit protection	YES
	over temperature protection	YES
	automatic restart	YES
	over load protection	YES
	surge capacity	L-N:1kV
Ambient and Life	Ta(°C)	-25...+45°C @ 110V~120V & 277V -25...+50°C @ 220V~240V
	Tc max. (°C)	90
	Storage Temperature(°C)	-30...80
	ambient humidity range	5%...85%RH, Not condensing
	audible noise(dB)	30dBA tested@10cm
Other	weight(g)	180g
	dimensions (LxWxH)(mm)	96X42X30/139X42X30
	casing material	Plastic
	housing colour	Grey+blue end cap
	connecting method	push-in terminal block
	type of protection	IP20
	protection class	ClassII for EU,class 2 for UL
Note	1. At 230Vac,50Hz,full load. 2. Tolerance:includes set up tolerance,line regulation and load regulation. 3. At 230Vac,50Hz,LED load,blew 200Hz	

Dimensions(mm):

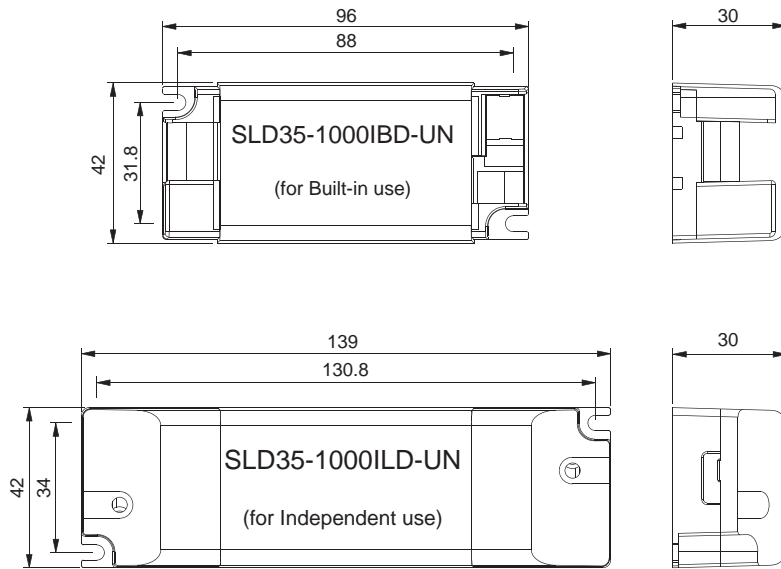

Wiring diagram:

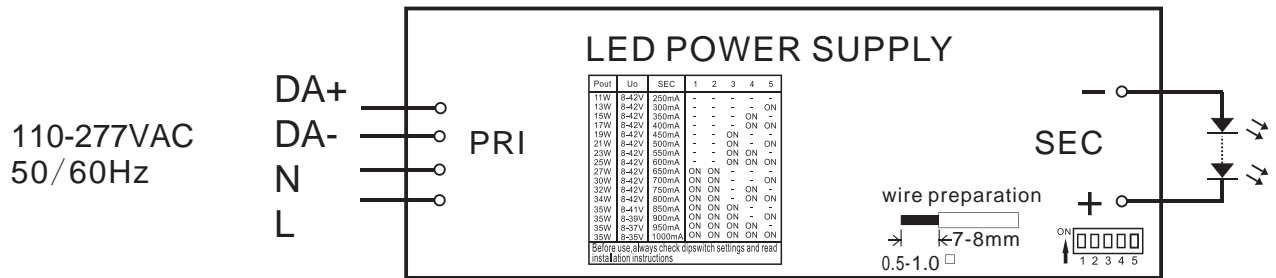

Application:

Built-in application



Independent application

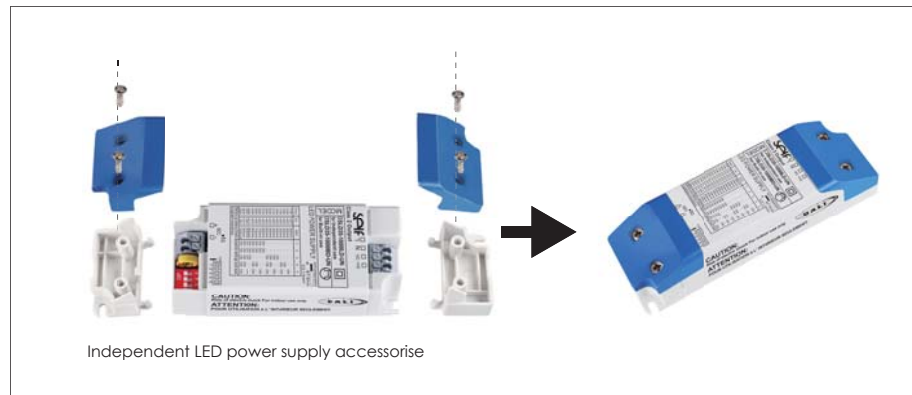

Electrical curves:

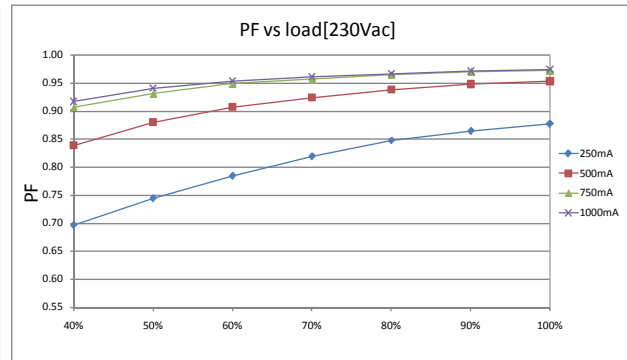
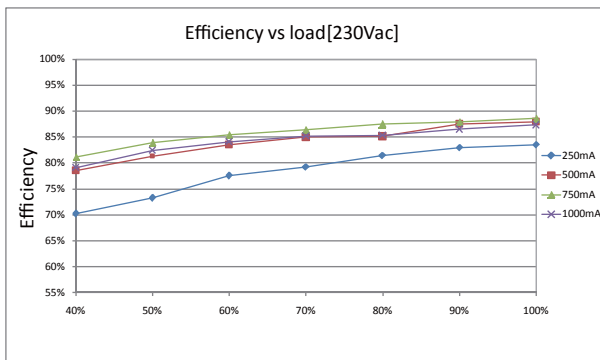
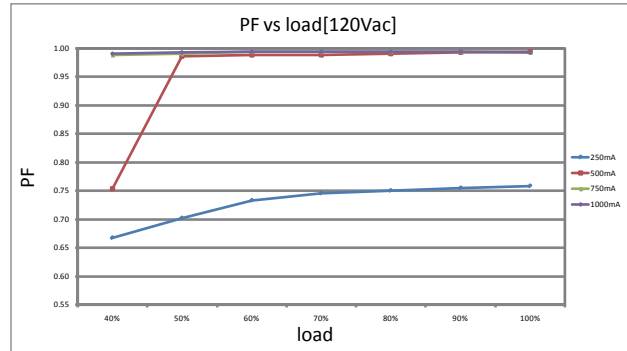
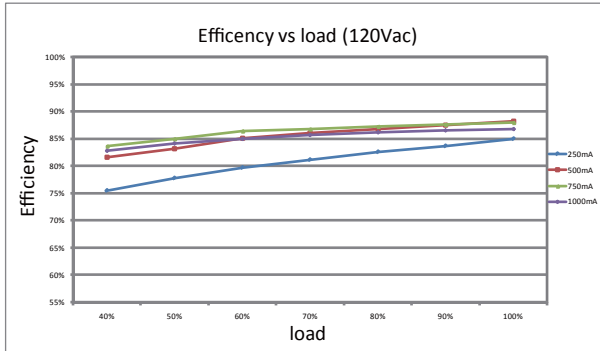

note

For constant current power supply,"LOAD" means the percentage of the maximum rated output voltage.
For constant voltage power supply,"LOAD" means the percentage of the maximum rated output current.

Sales & Technical Support:

Bright Green Connect Limited
Unit 3, Oyster Park
Byfleet
Surrey
KT14 7AX

+44 (0) 1932 497992

contact@brightgreenconnect.com

brightgreenconnect.com

*Due to continuous improvements and innovations,specifications are subjected to change without notice.